

LAKEVIEW ACADEMY STAIRS AND HANDRAIL PROFILE VIEW

SCALE: 1/2" = 1'-0"

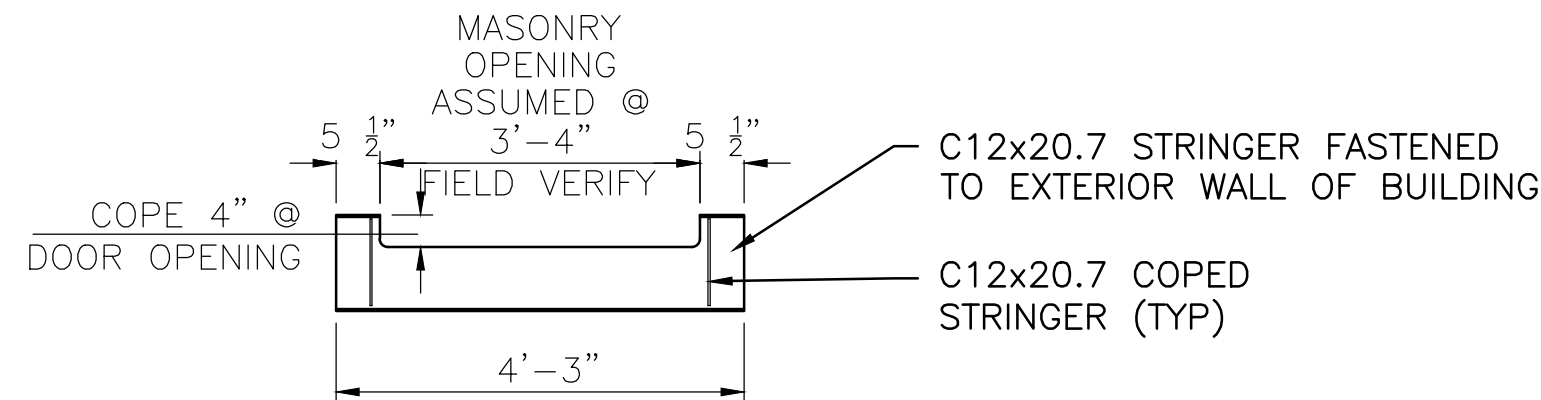

SECTION A-A

SCALE: 1/2" = 1'-0"

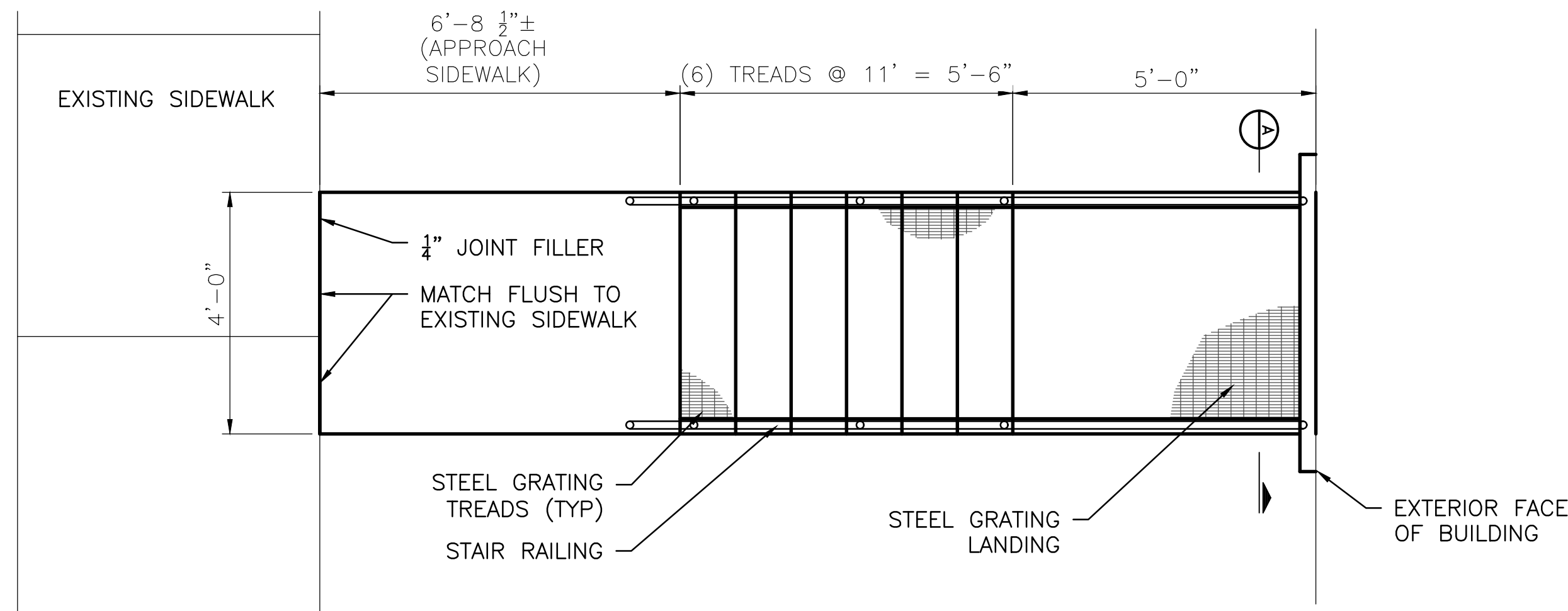

LAKEVIEW ACADEMY STAIRS AND HANDRAIL PLAN VIEW

SCALE: 1/2" = 1'-0"

NOTES:

1. GRATING SHALL BE GALVANIZED WELDED BAR GRATING WITH 1 1/4" x 3/8" BEARING BARS, 1 1/8" C/C SPACING WITH CROSS BARS @ 4" C/C.
2. GRATING SHALL BE ADA COMPLIANT.
3. STAIR TREADS SHALL BE 1 1/4" x 3/8" BEARING BARS, 1 1/8" C/C WITH CHECKERED PLATE NOSING.
4. ALL CUT EDGES SHALL BE Banded.
5. CONCRETE FOOTING SHALL BE f'c = 3,000 PSI CONCRETE, AIR ENTRAINED.
6. STEEL REINFORCING SHALL BE GRADE 60.
7. HANDRAIL AND STAIRWAY SHOP DRAWINGS SHALL BE PROVIDED FOR REVIEW PRIOR TO FABRICATION.
8. ALL HANDRAILS SHALL BE HOT DIPPED GALVANIZED AFTER FABRICATION PER ASTM-123, MIN 2.0 OZ/SFT. DRAINAGE HOLES SHALL BE PROVIDED IN THE UNDERSIDE OF THE HORIZONTAL RAILS. ALL FASTENERS AND STEEL APPURTENANCES SHALL BE HOT DIPPED GALVANIZED.
9. TOUCH UP ANY FIELD REPAIRS, WELDS, AND SCRATCHES IN STEEL WITH A COLD GALVANIZING COMPOUND APPLIED IN THE FIELD. IT SHALL CONTAIN A MINIMUM OF 95 PERCENT ZINC DUST AT 24 POUNDS PER GALLON IN A RESIN VEHICLE, MEETING FEDERAL SPECIFICATIONS MIL-P-21035.



EXAMPLE PHOTO

REV#	DATE	DESCRIPTION	BY