

CONSTRUCTION NOTES

- | NO. | DESCRIPTION |
|-----|---|
| 1 | INSTALL 8'H x 25'-10"L x 8'W DIVERSION STRUCTURE SEE DETAILS ON SHEETS C-2.08 AND SS-1.01 THRU SS-1.04 INCLUSIVE. |
| 2 | INSTALL 48" DIA DUAL WALL CORRUGATED HDPE STORM DRAIN DIVERSION PIPE W/ ALL REQUIRED FITTINGS AND APPURTENANCES. TRENCHING REQUIREMENTS PER GEOTECHNICAL REQUIREMENTS AND SUPPLEMENTED BY DETAIL B ON SHEET C-2.07. PIPE BEDDING SHALL BE SAND PER GEOTECHNICAL REQUIREMENT. SEE ALSO PROFILE AND DETAILS ON SHEETS C-2.02, C-2.09 & C2.10. |
| 9 | INSTALL TRAFFIC RATED 36" MANHOLE LID AND CONCRETE COLLAR PER DETAIL A ON SHEET C-2.07 AND DETAIL C ON SHEET C-2.07. |
| 12 | SEE STRUCTURAL / CONNECTION DETAILS PER SHEET SS-1.01 THRU SS-1.04 INCLUSIVE. |
| 20 | INSTALL 22.5" DEG DOUBLE WALL HDPE ELBOW (BELL) W/ S.S. BAND COUPLER RESTRAINT. |
| 21 | SLOPE FLOOR USING 5,000 PSI NON-SHRINK GROUT @ 2% SLOPE. |
| 22 | INSTALL MIN. 4-IN AB SUBGRADE PER GEOTECHNICAL RECOMMENDATION |
| 24 | INSTALL 6"W x 6"H LOW-FLOW THROUGH WITH 6" ANCHOR LIP (304 SS). |
| 25 | INSTALL 304 SS STIFFENER WELDED TO TROUGH EPOXY AND THREADED @ 24" O.C. |
| 26 | INSTALL 5/8" ANCHOR BOLT @ 12" O.C. (4" EMBEDMENT MIN.) |
| 27 | INSTALL 3.7' X 8' HEAVY DUTY CARBON STEEL GRATING WITH NOMINAL OPENING OF 6"W X 12"L. GRATING SEGMENTS SHALL BE FULLY BANDED. SEE ALSO SHEETS SS-1.01 THRU SS-1.04 INCLUSIVE AND SPECIFICATIONS. |

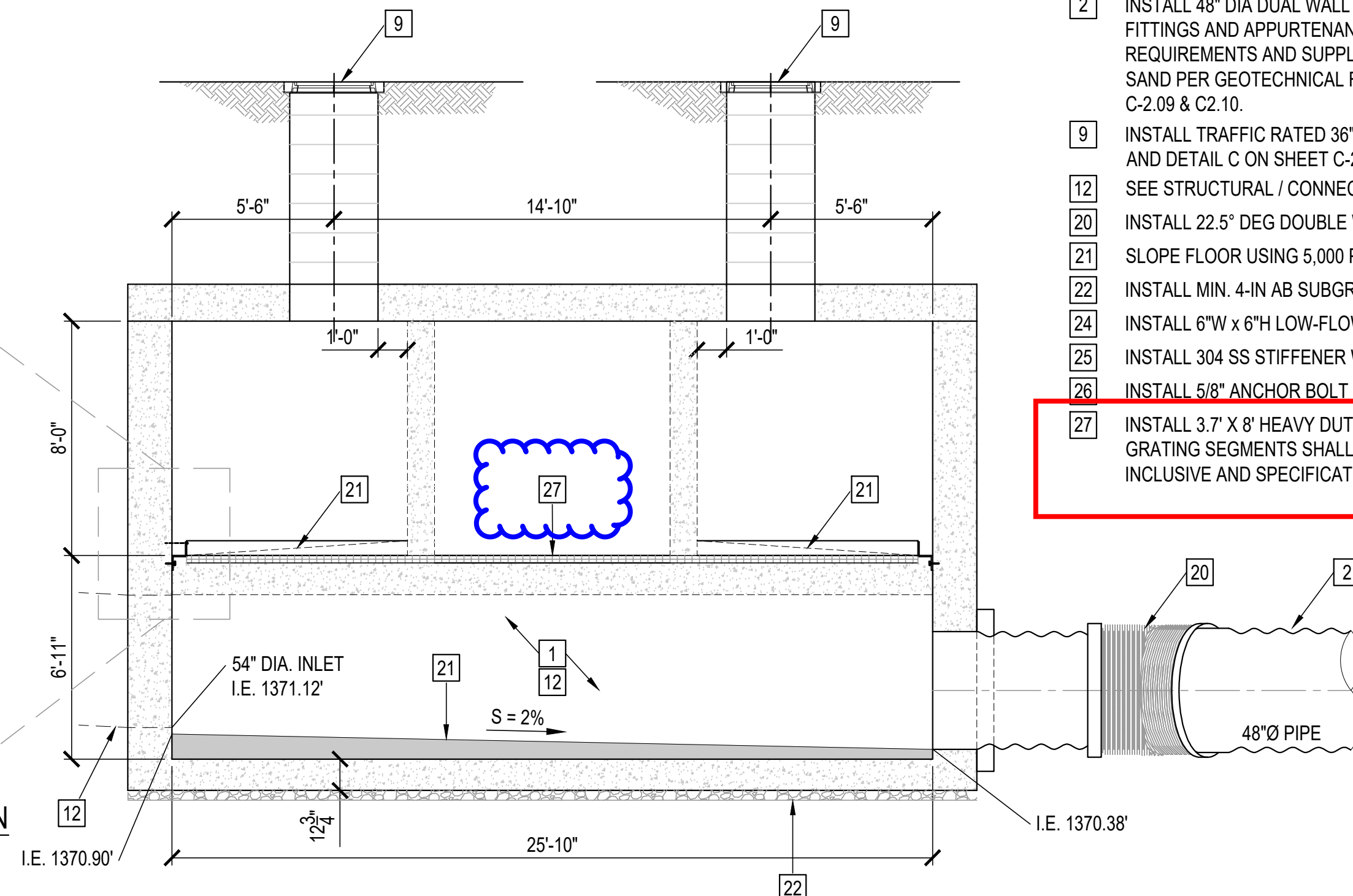
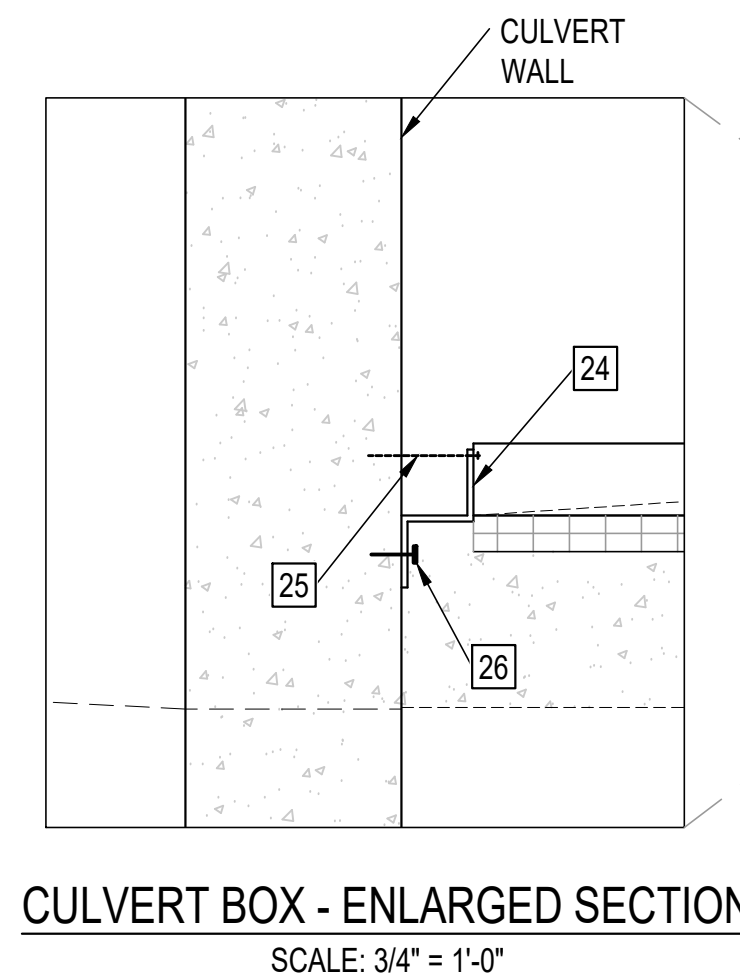
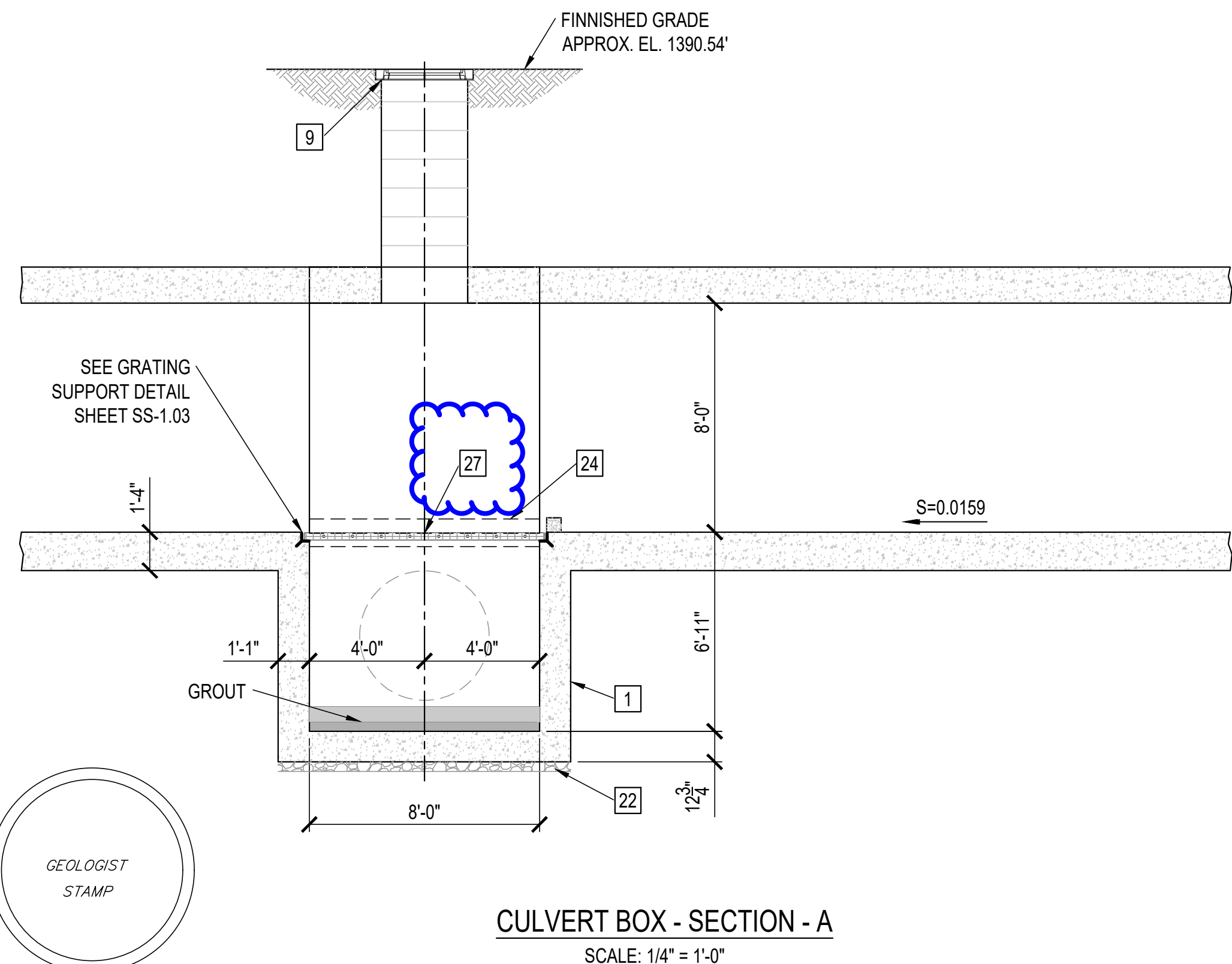

APPROVED FOR CONSTRUCTION BY:	APPROVED FOR CONSTRUCTION BY:
DIRECTOR OF NEIGHBORHOOD SERVICES	DIRECTOR OF ECONOMIC DEVELOPMENT
DATE:	DATE:

CULVERT BOX - SECTION - B
SCALE: 1/4" = 1'-0"

REVIEWED BY:	IN ACCORDANCE WITH RESOLUTION No. 19-6, AS A RESOLUTION OF THE CITY COUNCIL OF THE CITY OF SANTA CLARITA DELEGATION DISCRETIONARY AUTHORITY TO THE DIRECTOR OF PUBLIC WORKS, DIRECTOR OF RECREATION AND COMMUNITY SERVICES, DIRECTOR OF NEIGHBORHOOD SERVICES, CITY ENGINEER, AND ASSISTANT CITY ENGINEERS TO APPROVE PLANS AND DESIGNS FOR THE CONSTRUCTION OF OR IMPROVEMENTS TO PUBLIC PROPERTY FOR PURPOSES OF DESIGN IMMUNITY PURSUANT TO GOVERNMENT CODE SECTION 830.6 FOR THE CITY OF SANTA CLARITA, I DO HEREBY EXERCISE THE MODIFICATION TO THE PLAN OR DESIGN, OR A CONSTRUCTION OF, OR AN IMPROVEMENT TO THE PUBLIC FACILITY, STRUCTURE, OR PROPERTY TO WHICH THIS STATEMENT, MY SIGNATURE AND DATE IS AFFIXED.
PLAN CHECKER	DATE OF EXECUTION
APPROVED FOR CONSTRUCTION BY:	
DAMON LETZ	DATE OF EXECUTION
CITY ENGINEER	

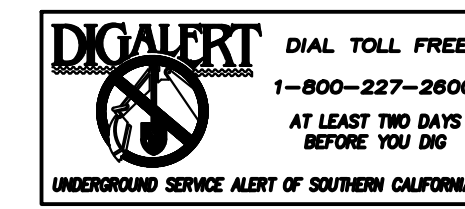

CITY OF SANTA CLARITA	
APPROVED FOR GRADING AND DRAINAGE UNDER TITLE 17 UNIFIED DEVELOPMENT CODE	
BY:	
DATE:	
THIS SET OF PLANS AND SPECIFICATIONS MUST BE KEPT ON THE JOB AT ALL TIMES. IT IS UNLAWFUL TO MAKE ANY CHANGES OR ALTERATIONS ON SAME WITHOUT WRITTEN PERMISSION FROM THE ENGINEERING SERVICES DIVISION.	
THE STAMPING OF THESE PLANS AND SPECIFICATIONS SHALL NOT BE USED AS A SUBSTITUTE FOR PERMIT OR MEANT AS AN APPROVAL OF ANY VIOLATION OF THE PROVISIONS OF ANY CITY OR COUNTRY ORDINANCE OR STATE LAW.	
SCALE:	AS SHOWN
DATE:	03/19/2024
JOB NO.	1SAN271102
SHEET:	C-2.08
OF XXX	

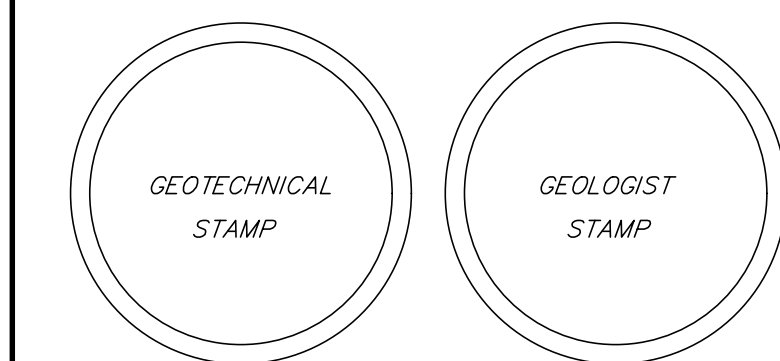

GEOTECHNICAL REVIEW BY: NINYO & MOORE 475 GODDARD, SUITE 200 IRVINE, CA 92618 (949) 753-7070 www.ninyoandmoore.com	PLANS PREPARED UNDER THE DIRECTION OF: MATTHEW HARRELL CEG # 2537
---	--

PLANS PREPARED FOR: CITY OF SANTA CLARITA 23920 VALENCIA BLVD., SUITE 300 SANTA CLARITA, CA 91355 (661) 255-4942
--

PLANS PREPARED BY: PACE Advanced Water Engineering 17520 Newhope Street, Suite 200 Fountain Valley, CA 92708 P: (714) 481-7300 www.pacewater.com

