

LAST PLOT DATE: 02/20/2017 10:29 PM

1
2
3
4
5
6
7
8
9
10
11

											SEAL:	THIS DRAWING OR BILL OF MATERIAL IS CONFIDENTIAL AND MAY NOT BE LOANED, REPRODUCED OR COPIED, EITHER WHOLLY OR IN PART, OR MADE PUBLIC IN ANY MANNER WITHOUT THE WRITTEN CONSENT OF DUKE ENERGY CORPORATION.	DRAFTED BY:	<input type="checkbox"/> PRELIMINARY <input type="checkbox"/> APPROVAL	TITLE: DRAWING FOR GRATING ESTIMATE 12.47KV BUS 2 SWITCHGEAR PIT (SGF-2A)
											DESIGNED/CHECKED BY:		<input type="checkbox"/> AS BUILT		
											ENGINEER:		DATE _____ NAME _____	LOCATION: COVINGTON SUBSTATION	
											DETAIL PROJECT NO: D1912DS1		DATE ISSUED: ?/??/17	SCALE: AS NOTED	SCALE FACTOR: 1



DATE AND TIME

2

ESTIMATE

4

5

6

7

8

9

10

11

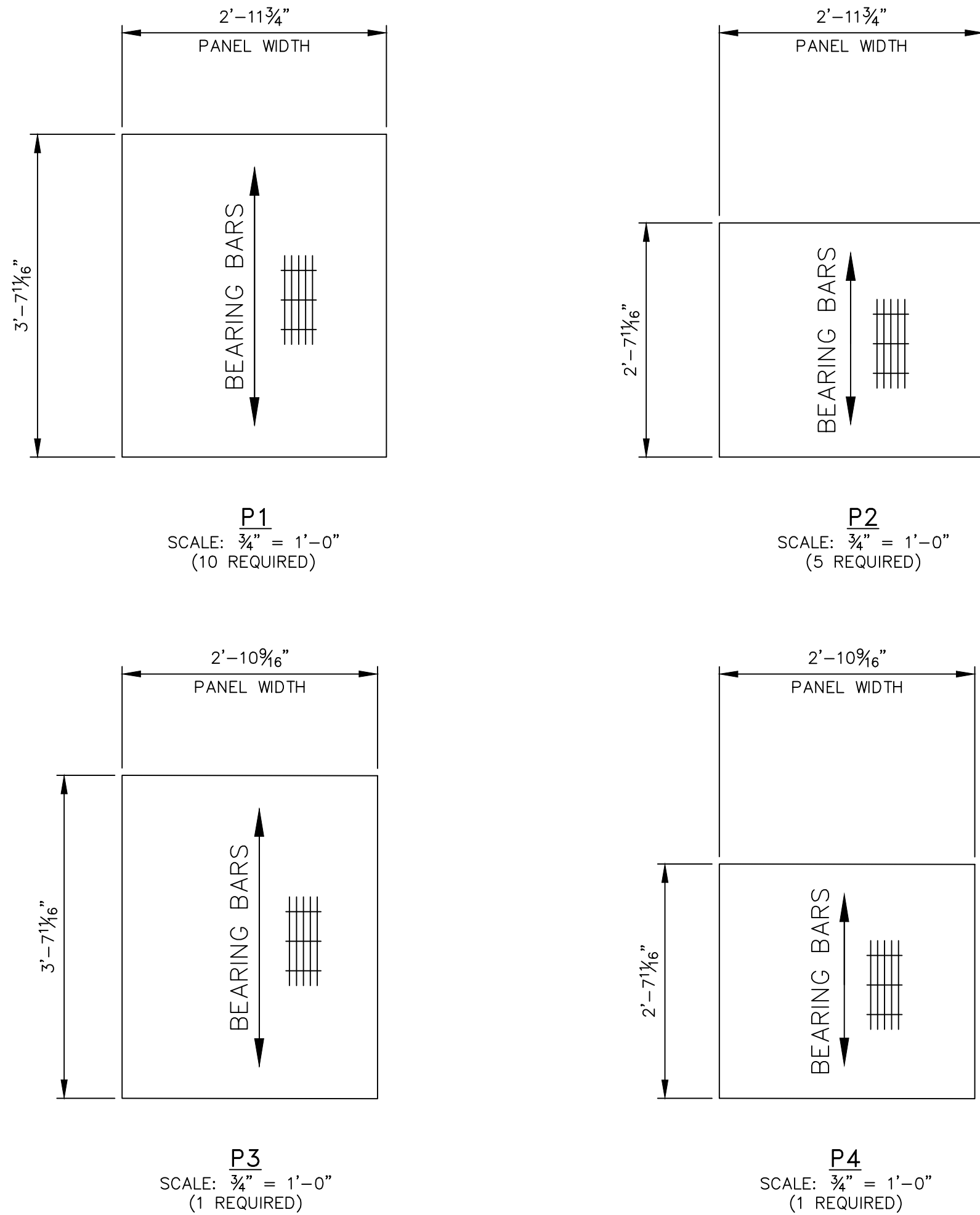

GRATING PANEL DETAILS
SEE NOTE 8

STRUCTURAL STEEL NOTES:

- FABRICATION AND ERECTION OF STRUCTURAL STEEL SHALL BE IN ACCORDANCE WITH THE AMERICAN INSTITUTE OF STEEL CONSTRUCTION (AISC), "MANUAL OF STEEL CONSTRUCTION", LATEST EDITION.
- ALL STRUCTURAL STEEL SHALL BE GALVANIZED AFTER FABRICATION IN ACCORDANCE WITH ASTM A123.
- ALL NUTS SHALL BE ASTM A563 AND SUPPLIED AS A MANUFACTURED MATCHED ASSEMBLY WITH THE APPROPRIATE SIZE ASTM A325 BOLT.
- ALL HARDWARE SHALL BE GALVANIZED IN ACCORDANCE WITH ASTM A153.
- WELDING SHALL BE PERFORMED ONLY BY APPROVED WELDERS AND CONFORM TO THE LATEST PROVISIONS OF THE AMERICAN WELDING SOCIETY (AWS), "STRUCTURAL STEEL WELDING CODE", AWS D1.1. AWS A5.1 OR A5.5 WITH E70XX ELECTRODES OR EQUIVALENT, SHALL BE USED UNLESS OTHERWISE NOTED.
- SHOP AND FIELD TOUCHUP OF GALVANIZING SHALL BE DONE USING BRUSH-APPLIED ORGANIC ZINC RICH PAINT, IN ACCORDANCE WITH ASTM A780.
- ALL HOLES SHALL BE 3/4" DIA. FOR A 5/8" DIA. BOLT UNLESS NOTED OTHERWISE.
- ALL GRATING SHALL BE GALVANIZED AND Banded LIGHT DUTY 19W4 WITH 1" X 3/16" BAR SIZE BY BROWN-CAMPBELL COMPANY, 11415 GROOMS ROAD, BLUE ASH, OHIO 45242, (513) 489-0011.

REFERENCES:

- | | |
|-----------|--------------------------------------------------------------|
| 79400-E1 | LOCATION PLAN OF 69KV TO 12.47KV SUBSTATION |
| 79400-E2 | STRUCTURAL/ELECTRIAL PLAN OF 69KV TO 12.47KV SUBSTATION |
| 79400-E3 | GROUNDING PLAN OF OF 69KV TO 12.47KV SUBSTATION |
| 79400-E4 | CABLE ROUTING PLAN OF 69KV TO 12.47KV SUBSTATION |
| 79400-S1 | GRADING & EROSION CONTROL PLAN OF 69KV TO 12.47KV SUBSTATION |
| 79400-S2A | FOUNDATION DETAILS OF 69KV TO 12.47KV SUBSTATION-SHEET 1 |
| 79400-S2B | FOUNDATION DETAILS OF 69KV TO 12.47KV SUBSTATION-SHEET 2 |
| 79400-S2C | FOUNDATION DETAILS OF 12.47KV BUS 2 SWITCHGEAR-SHEET 1 |
| 79400-S2E | FOUNDATION DETAILS OF 12.47KV BUS 2 SWITCHGEAR-SHEET 3 |
| 79400-S2F | FOUNDATION DETAILS OF 12.47KV BUS 2 SWITCHGEAR-SHEET 4 |

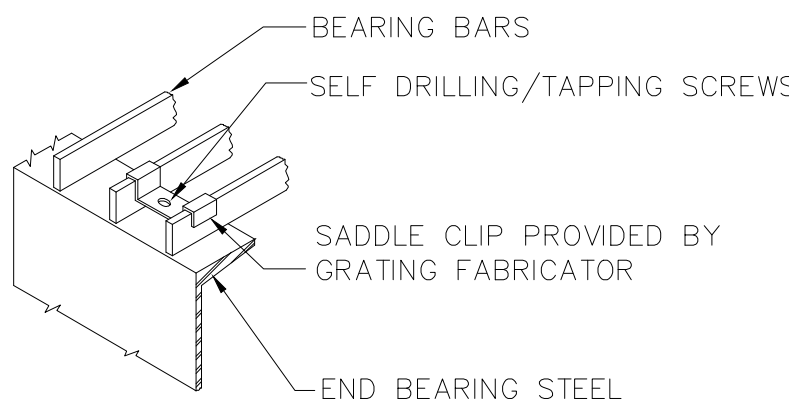
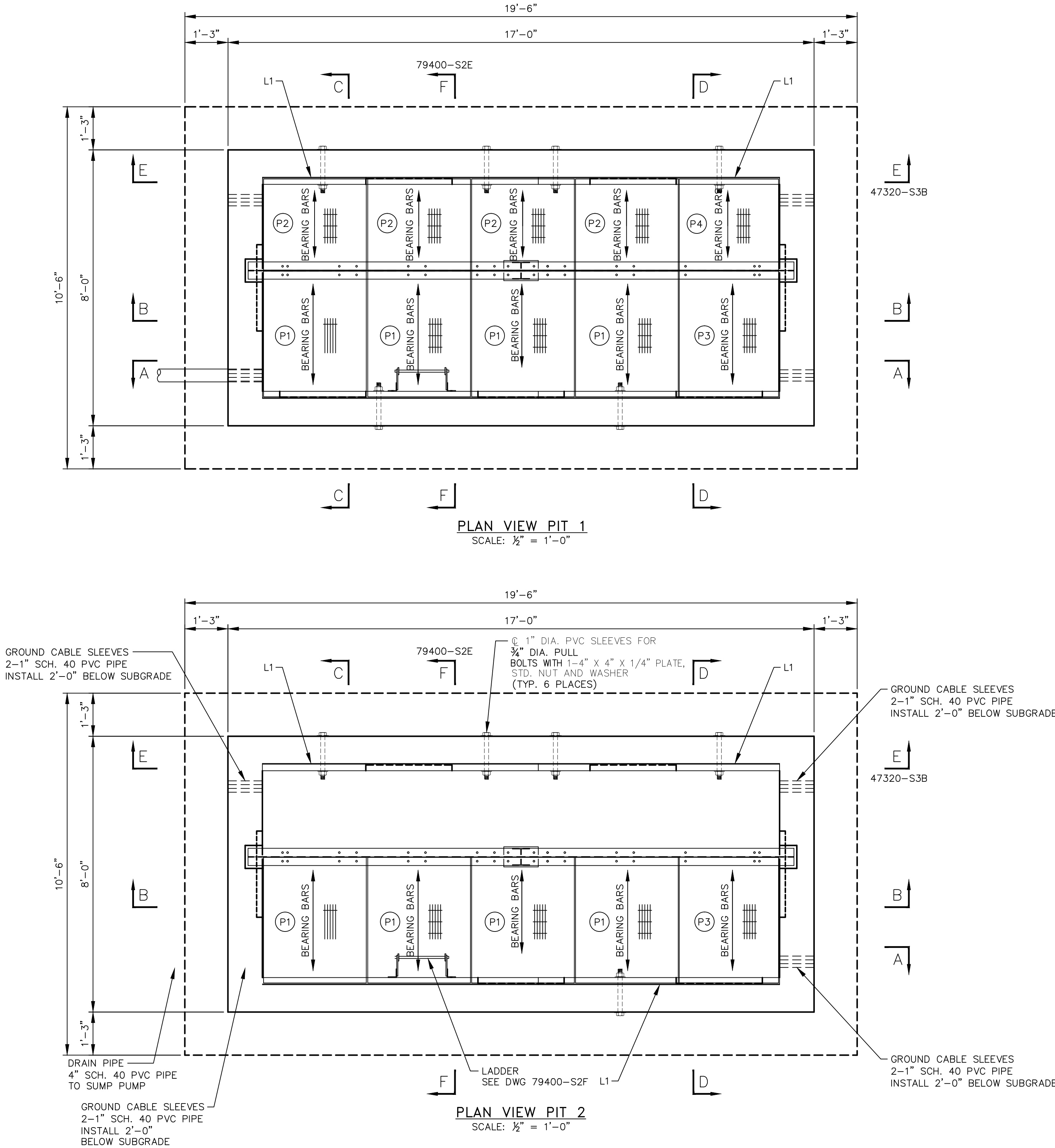

SADDLE CLIP FASTENER

FASTENERS TO BE LOCATED AT TWO CORNERS OF EACH GRATING SECTION, BETWEEN FIRST AND SECOND BEARING BARS AND SEATED ON TOP