

1/2" DIA STAINLESS STEEL SCREW  
ANCHOR AT 3'-0" O.C. MAX IN  
SHORT- SLOTTED HOLES, (MIN. 4  
PER GRATING PANEL), PROVIDE 4  
1/4" EMBEDMENT. SLOT HOLES IN  
NORTH-SOUTH DIRECTION

1/4" THICK X 2" SQUARE  
STEEL STAINLESS ANCHOR  
BLOCK, SHOP WELDED TO  
BEARING BARS

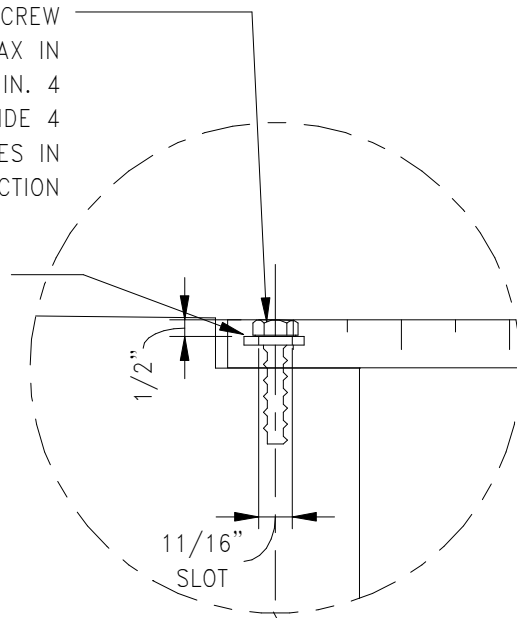

## Slip-Resistant Surface

Quantity	Width	Length
20	9 1/2"	11'-11 5/8"
1	9 1/2"	11'-3 1/8"
2	9 1/2"	10'-11 13/16"
1	9 1/2"	6'-1 1/16"
2	9 1/2"	5'-11 5/8"
1	9 1/2"	5'-5 13/16"
1	9 1/2"	4'-9 1/8"
1	9 1/2"	4'-4 1/8"
1	9 1/2"	3'-6 3/8"
1	9 1/2"	2'-9 7/8"

## Grating SS316

STAINLESS STEEL GRATING WITH 1"X1/4"  
BEARING BARS SPACED AT 1/2" ON  
CENTER. CROSS BARS SHALL BE AT 2" ON  
CENTER. PROVIDE SLIP-RESISTANT COATING

**Banded all sides**

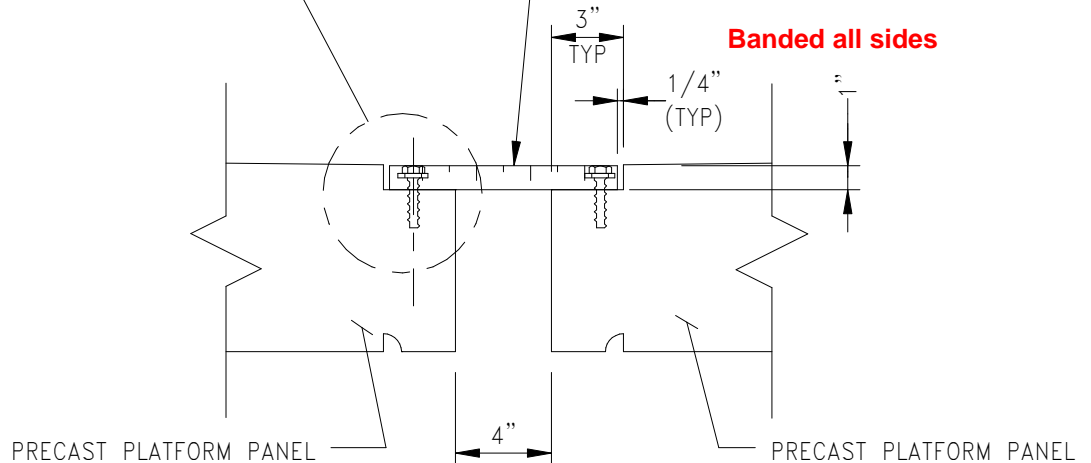

### NOTE:

1. STOP TRENCH DRAIN GRATE 1'-6" FROM ENDS OF PRECAST PLATFORM PANELS.

## 6 SECTION - TRENCH DRAIN GRATE

S306

SCALE: 1 1/2" = 1'-0"